

PISTON, PISTON RING, PISTON PIN CONSTRUCTION [ZJ, Z6]

B3E011011010T01

- The pistons are made of heat resistant, highly conductive aluminium alloy.
- Offset pistons are used to reduce piston-slapping noise.
- To prevent the piston from being reassembled in the wrong direction, an "F" mark is located on the side of piston.
- The ZJ engine model piston has valve recesses on the intake side. The Z6 engine model has valve recesses on the intake and exhaust sides.

Piston specification

Item		ZJ	Z6
Outer diameter	(mm {in})	73.97-73.98 {2.9122-2.9125}	77.97-77.98 {3.0697-3.0700}
Offset quantity	(mm {in})	0.5 {0.0197}	
Compression height: HC	(mm {in})	27.38-27.48 {1.0780-1.0818}	29.68-29.78 {1.1685-1.1724}
Piston height: HD	(mm {in})	45.93 {1.8083}	48.23 {1.8988}

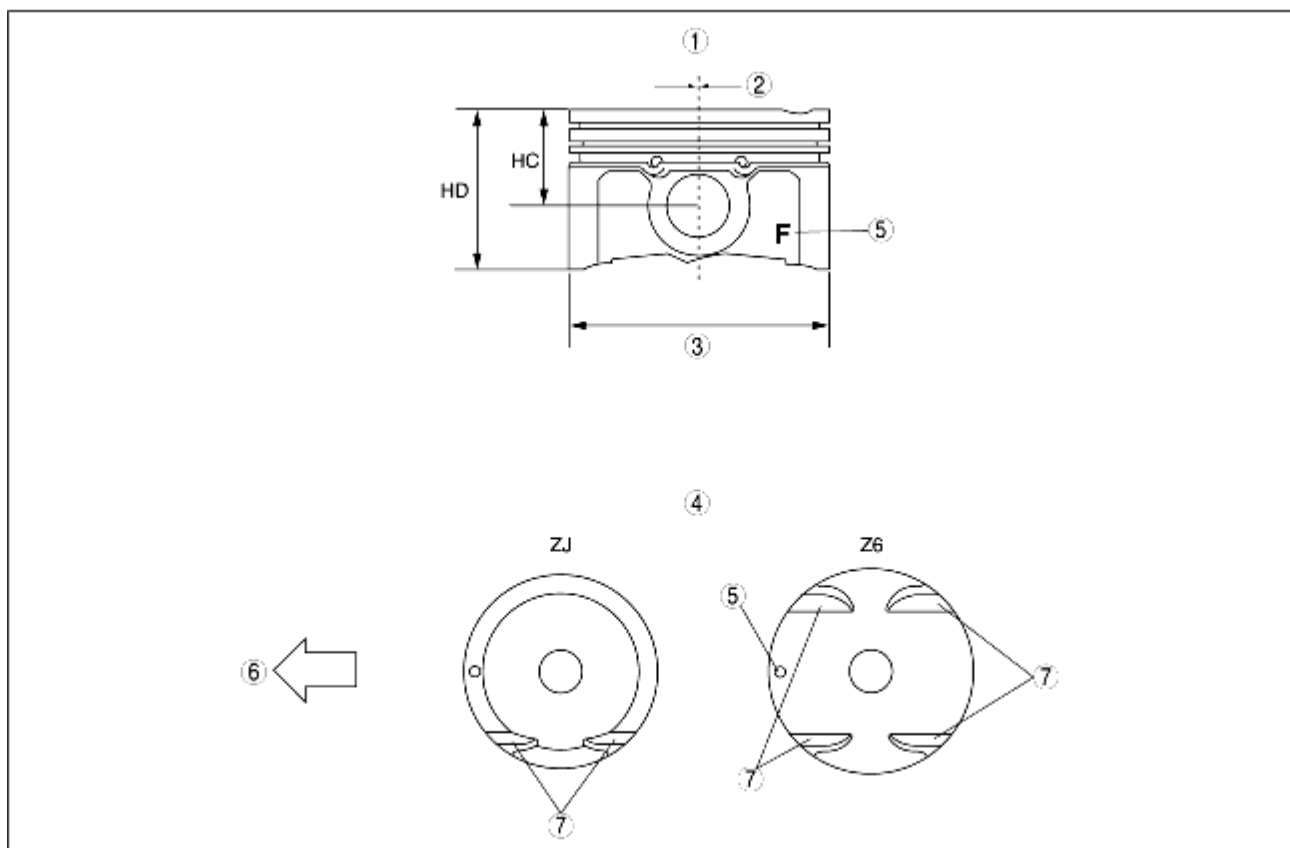

B3E01 10T034

1	Piston side view
2	Offset
3	Outer diameter
4	Piston upper view
5	Front mark
6	Engine front side
7	Valve recess

• The following piston rings have been adopted: A barrel face ring for the top ring, a taper-under cut ring for the second ring, two side rails and an expander for the oil ring. Also, low tensile load oil rings have been adopted for friction reduction and fuel consumption improvement.

• The piston pin is made of chrome steel alloy with superior rigidity.

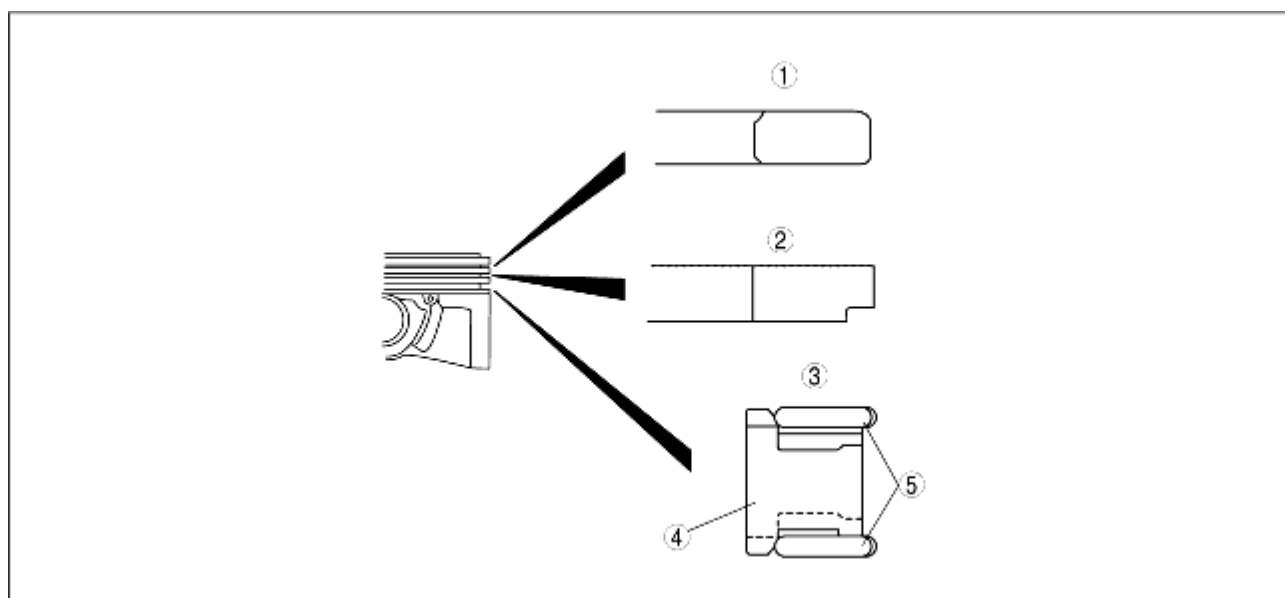

B3E01 10T014

1	Top ring sectional view
2	Second ring sectional view
3	Oil ring sectional view
4	Expander
5	Side rail